

**Warewashing
Electric Rack Type Dishwasher
with 1 Speed, Single rinse and
Pressure Boiler-90 baskets/h**

ITEM # _____

MODEL # _____

NAME # _____

SIS # _____

AIA # _____



Warewashing

Electric Rack Type Dishwasher with 1 Speed, Single rinse and Pressure Boiler-90 baskets/h

534314 (RTCS90ERB)	Rack type dishwasher, electric, r>l, 1 speed, pressure boiler, 90b/h
534315 (RTCS90ELB)	Rack type dishwasher, electric, l>r, 1 speed, pressure boiler, 90b/h

Short Form Specification

Item No. _____

304 AISI stainless steel front and side panels, strainers and wash and rinse arms. Pressed wash tank (100 liters) for easier cleaning. Washing tubes in stainless steel. Double-skinned construction and counter balanced door. Built-in pressure boiler. Self draining wash pump. Automatic start/stop function. Wash and single rinse in one compact module. 1 speed. Electric heating. HACCP autodiagnostic check control. Feeding direction: right to left. Hourly capacity: 1620 dishes/90 baskets.

Main Features

- Built-in rinse water heater to increase the temperature of the final rinse water.
- One conveyor speed of 90 racks/hour which can be selected from the control panel by the operator.
- Pressure boiler.
- Powerful 2 hp (1.5 kW) wash pump.
- Low water consumption.
- Large counter balanced inspection doors allow unrestricted all round access to the wash and rinse area. Door is insulated with injected foam. This adds strength as well as reduces noise and heat loss.
- Large filters sloping towards the front to the smaller pressed filter box for quick removal. Filters feature holes smaller than the concave ant-block wash nozzles so large food cannot enter and block the wash system.
- Wash and rinse arms can be easily removed for cleaning.
- Deep drawn pressed wash tank with fully rounded corners, sloped towards the drain to prevent dirt build up provides fast drainage in only a few minutes. Pressed wash tank with no welded points offer a guaranteed water tight solution.
- Washing cycle is carried out with water circulating at a temperature of 55-65 °C, whereas the rinsing cycle is carried out with clean water coming from the water system, heated to a max. temperature of 80-90 °C.
- Adjustable feet for full access underneath the machine for cleaning.
- Push button self cleaning cycle of the wash and rinse zones for ease of "end of day" cleaning.
- Wash chamber without internal pipes and therefore no hidden dirt traps.
- Self draining wash pumps provide maximum hygiene with no smells and all wash and rinse zones drain automatically at the push of a button.
- Dishwasher structure is held together with a solid 2" x 2" (50 x 50mm) Stainless steel tube sub-frame to provide long term sturdiness.
- All main components made in heavy duty anti-corrosive 304 type Stainless steel: tanks, front and side panels, wash & rinse arms and caps, doors, front, handle and rack transportation system.
- Autostart/stop ensures that the machine runs only when a rack is passing through it. This reduces both water and energy consumption.
- Electronic control panel features large display to read wash and rinse temperatures.
- Machine predisposed for external detergent and rinse aid connections.
- IPX5 water protection.

**Warewashing
Electric Rack Type Dishwasher with 1 Speed, Single rinse and
Pressure Boiler-90 baskets/h**

APPROVAL: _____

Optional Accessories

- Drain kit for modular and compact rack type dishwashers PNC 864150
- Kit of 12 stainless steel plugs for washing arms for modular and compact rack type PNC 864239
- Splash hood for rack type, right side PNC 864247
- Splash hood for rack type, left side PNC 864248
- Air gap for compact rack type PNC 864309
- Electric hot air blower, 600mm, for compact rack type, right>left (only for 534314) PNC 864506
- Electric hot air blower, 600mm, for compact rack type, left>right (only for 534315) PNC 864507
- Electric drying tunnel, 900mm, with door, for compact rack type, right>left (only for 534314) PNC 864516
- Electric drying tunnel, 900mm, with door, for compact rack type, left>right (only for 534315) PNC 864517
- Electric drying tunnel, 600mm, with door, for compact rack type, right>left (only for 534314) PNC 864518
- Electric drying tunnel, 600mm, with door, for compact rack type, left>right (only for 534315) PNC 864519
- Electric corner drying tunnel, for compact rack type, right>left (only for 534314) PNC 864520
- Electric corner drying tunnel, for compact rack type, left>right (only for 534315) PNC 864521
- Basket for 5 half insulated trays 530x370 mm - red PNC 867005
- Kit 6 baskets for 1-tank Rack Type dishwashers PNC 867050
- Kit 9 baskets for 1-tank Rack Type dishwashers PNC 867051

Front

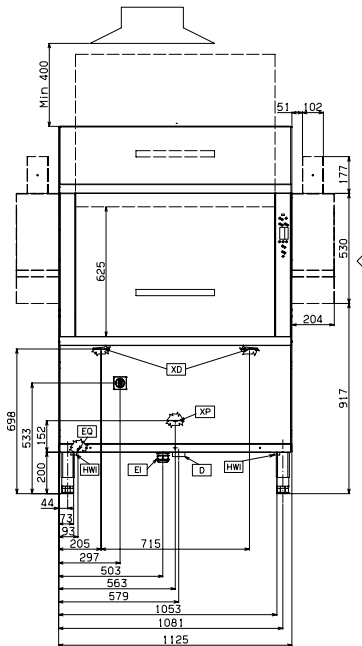

Top

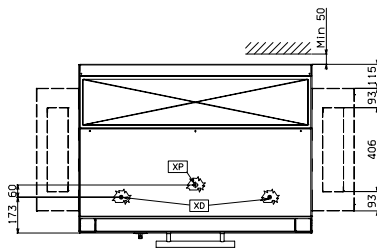

- D** = Drain
- EI** = Electrical connection
- HWI** = Hot water inlet
- V** = Air vents

Side

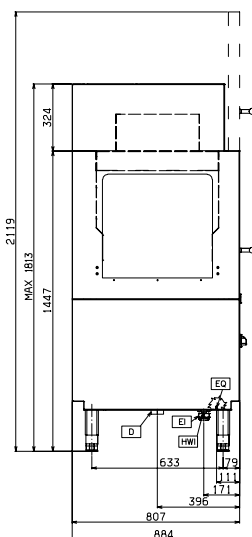

Electric

Supply voltage:

- 534314 (RTCS90ERB) 400 V/3N ph/50 Hz
- 534315 (RTCS90ELB) 400 V/3N ph/50 Hz

Water

Inlet Water supply pressure: 44 - 102 psi (3 - 7 bar)

Inlet Cold Water Supply
Temperature for pre wash section:

- Inlet Hot Water Supply Temperature for wash section: 50 °C
- Inlet Water supply hardness: 4-8 gpg (7-14 °fH)

Incoming Cold Water line size (pre wash):

Incoming Hot water line size (wash section): G 3/4"

Drain line size (pre wash section): G 1 1/2"

Drain line size (wash section): G 1 1/2"

Hot Water consumption: Liters/hr: 240 liters/hr

Pre wash temperature:

Pre wash tank size:

Pre wash pump power:

Pre wash pump water flow: 0 l/min

Wash Temperature: 55-65 °C

Wash tank size: 100 liters

Wash pump power: 1.0 kW

Wash pump water flow: 300 l/min

Final Rinse Temperature: 80-90 °C

Booster heating power: 16 hp (12 kW)

Final Rinse water flow: 240 liters/hr

Hot water booster capacity: 12 liters

Key Information

Productivity racks per hour (max speed): 90 racks/ 1620 dishes

Productivity racks per hour (min speed):

Height with door open: 2119 mm

Charging hole size (width): 530 mm

Charging hole size (height): 501 mm

External dimensions, Height: 1771 mm

External dimensions, Width: 1124 mm

External dimensions, Depth: 884 mm

Net weight: 459 kg

Shipping weight: 549 kg

Shipping height: 2060 mm

Shipping width: 1890 mm

Shipping depth: 1040 mm

Shipping volume: 4.05 m³

Noise level: <70 dBA