

## Roll-in 2 Door Hot Cupboard, 1600lt (+50/+75) - Pass-through

ITEM # \_\_\_\_\_

MODEL # \_\_\_\_\_

NAME # \_\_\_\_\_

SIS # \_\_\_\_\_

AIA # \_\_\_\_\_



726516 (R116H2FT)

2-door roll-in pass-through hot cupboard 1600lt, +50/+75°C, AISI 304

### Short Form Specification

**Item No.** \_\_\_\_\_

External and internal in AISI 304 stainless steel. Body insulation thickness 72mm. N. 2 full doors (pass-through). Ventilated operating mode; digital control; external digital temperature display. Operating temperature +50/+75°C.

### Main Features

- Two full doors.
- The operating temperature can be adjusted from 50 to 75 °C to suit both meat and dairy storage requirements.
- Simple control panel: on/off switch and digital temperature display.
- Universal shock-protectors on all sides.

### Construction

- Interior cell is entirely constructed in 304 AISI stainless steel.
- Exterior finish in AISI 304 stainless steel for easy cleaning.
- 72 mm thick insulation with cyclopentane injection for long-term insulation and energy saving.
- Developed and produced in ISO 9001 and ISO 14001 certified factory.

### Optional Accessories

- 17x2/1GN container trolley  PNC 361258
- 17x2/1GN compact container trolley  PNC 361260
- Trolley for 2/1GN roll-in rack  PNC 880017
- Base for roll-in-rack  PNC 880018
- Humidifier kit for hot roll-in cabinet, 1600lt  PNC 880188
- Kit with 2 hinges for door reversibility  PNC 881432
- 2/1GN roll-in rack  PNC 881449
- Trolley with 92-plate capacity banquet rack for 20x2/1GN ovens and bcf (85mm pitch)  PNC 922055

APPROVAL: \_\_\_\_\_

# Roll-in 2 Door Hot Cupboard, 1600lt (+50/+75) - Pass-through

**Front**

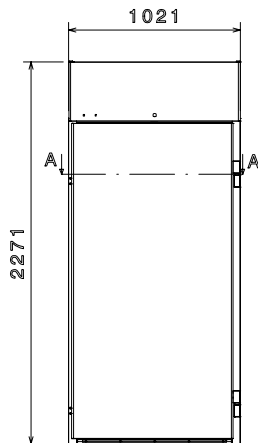

**Side**

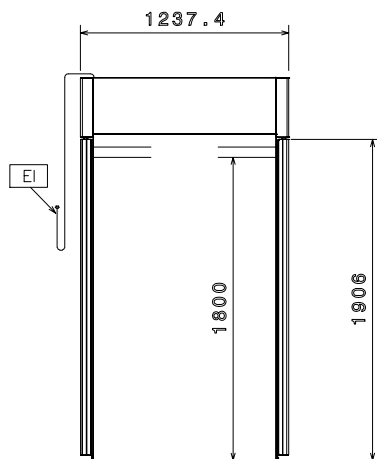

EI = Electrical connection  
RI = Refrigerant Inlet  
RO = Refrigerant Outlet

**Top**

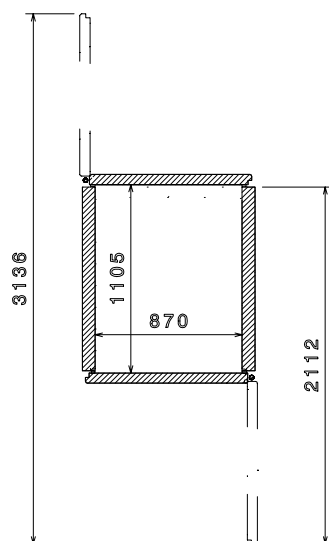

## Electric

Supply voltage:  
726516 (R116H2FT) 400 V/3N ph/50 Hz  
Electrical power, max: 1.91 kW

## Key Information

Gross capacity 1630 lt  
N° of doors: 2  
Door hinges: Right Side  
External dimensions, Width 1021 mm  
External dimensions, Height 2271 mm  
External dimensions, Depth 1238 mm  
Type of external material: 304 AISI  
Type of internal material: 304 AISI  
External side panels: 304 AISI  
External top panels: 304 AISI  
External door material: 304 AISI  
Internal panels material: 304 AISI  
Internal side panels material 304 AISI

## Refrigeration Data

Control type: Digital  
Operating temperature min.: 50 °C  
Operating temperature max.: 75 °C  
Operating mode: Ventilated

Roll-in  
2 Door Hot Cupboard, 1600lt (+50/+75) - Pass-through

The company reserves the right to make modifications to the products without prior notice. All information correct at time of printing.