

## Roll-in 2 Door Refrigerator, 1600lt (+2/+10) - Pass-through

ITEM # \_\_\_\_\_

MODEL # \_\_\_\_\_

NAME # \_\_\_\_\_

SIS # \_\_\_\_\_

AIA # \_\_\_\_\_



726497 (RI16R2FT)

2-door roll-in pass-through refrigerator, 1600 lt, +2/+10°C, AISI 304

### Short Form Specification

**Item No.** \_\_\_\_\_

External and internal in AISI 304 stainless steel. Body insulation thickness 75mm. N. 1 full door each side with heated frame. Built-in refrigeration unit; ventilated operating mode; digital control; automatic defrost; external digital temperature display. Operating temperature +2/+10°C. For ambient temperatures up to 43°C. CFC and HCFC free. R134a gas in refrigeration circuit. Gas in foam: Cyclopentane.

### Main Features

- Two full doors.
- The operating temperature can be adjusted from +2 to +10°C to suit both meat and dairy storage requirements.
- Simple control panel: on/off switch, high/low humidity switch and digital temperature display.
- Automatic defrost and automatic evaporation of defrost water.
- Ventilated cooling for optimal temperature distribution.
- Simple cooling unit easily accessible from the rear of the appliance.
- Universal shock-protectors on all sides.
- Complies with main international certification bodies and is CE marked.
- Plug-in installation: 1 phase, 220/240V supply.

### Construction

- Built-in compressor to suit operating conditions.
- Interior cell and external panel are constructed in 304 AISI stainless steel.
- 75 mm thick insulation, with cyclopentane injection for long-term insulation and energy saving.
- Refrigerant type: R134a.
- Developed and produced in ISO 9001 and ISO 14001 certified factory.
- Finished in top quality materials to ensure durability.
- CFC and HCFC free (ecological refrigerant type: R134a, - gas in foam: cyclopentane).

### Optional Accessories

- Trolley for 2/1GN roll-in rack  PNC 880017
- Base for roll-in-rack  PNC 880018
- Kit with 2 hinges for door reversibility  PNC 881432
- 2/1GN roll-in rack  PNC 881449
- Trolley with 92-plate capacity banquet rack for 20x2/1GN ovens and bcf (85mm pitch)  PNC 922055
- Trolley for 20 2/1 GN roll-in rack  PNC 922134
- Base for 20 2/1 GN roll-in rack  PNC 922142
- KIT HACCP EKIS  PNC 922166
- 60-mm pitch roll-in rack for 20 2/1 GN  PNC 922204
- 80-mm pitch roll-in rack for 14 2/1 GN  PNC 922206

APPROVAL: \_\_\_\_\_

## Roll-in 2 Door Refrigerator, 1600lt (+2/+10) - Pass-through

**Front**

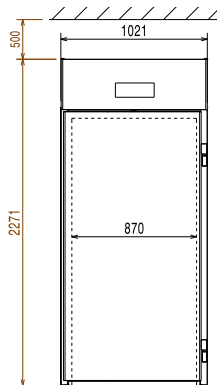

**Side**

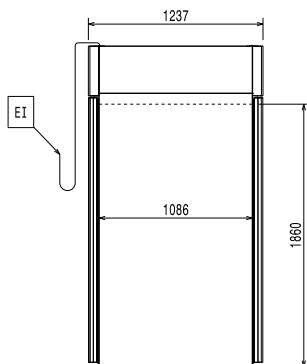

EI = Electrical connection  
RI = Refrigerant Inlet  
RO = Refrigerant Outlet

**Top**

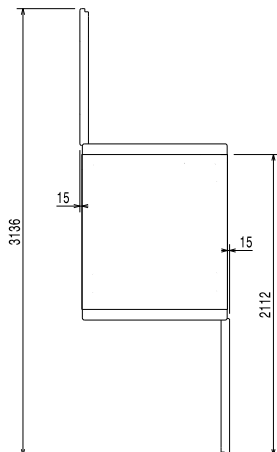

### Electric

Supply voltage:

726497 (RI16R2FT) 230 V/1 ph/50 Hz

Electrical power, max:

0.56 kW

### Key Information

Gross capacity	1630 lt
N° of doors:	2
Door hinges:	1 Left+1 Right
External dimensions, Width	1021 mm
External dimensions, Height	2271 mm
External dimensions, Depth	1237 mm
Noise level:	56,5 dBA
Type of external material:	304 AISI
Type of internal material:	304 AISI
External side panels:	304 AISI
External top panels:	304 AISI
External door material:	304 AISI
Internal panels material:	304 AISI
Internal side panels material	304 AISI

**Built-in Compressor and Refrigeration Unit**

### Refrigeration Data

Control type:	Digital
Compressor power:	3/8 hp
Refrigerant type:	R134a
Refrigeration power:	546 W
Refrigeration power at evaporation temperature:	-10 °C
Refrigerant weight:	340 g
Min/Max internal humidity	60/72
Operating temperature min.:	2 °C
Operating temperature max.:	10 °C
Operating mode	Ventilated
Cooling unit	Built-In
Defrost type	Automatic

Roll-in  
2 Door Refrigerator, 1600lt (+2/+10) - Pass-through

The company reserves the right to make modifications to the products without prior notice. All information correct at time of printing.

2018.06.14