

ALPENINOX

Pastry and Bakery Line 2x1/2 Doors Digital Refrigerator -2°/+7°C, 600x800 grid

ITEM # _____

MODEL # _____

NAME # _____

SIS # _____

AIA # _____



728853 (AFX682HFR)

2-half door refrigerator,
600x800 mm grids, -2+7°C,
AISI 304

Short Form Specification

Item No. _____

Two half door refrigerator constructed in 304 AISI stainless steel. Large display featuring cabinet temperature display, setting and humidity selection button (low and high). Refrigerators model has operating temperature that can be adjusted from -2° to +7°C. Back-air conveyor and ducts ensure an even airflow and constant results. Internal structure with runners and supports in AISI 304 stainless steel that are easy to disassemble and permit numerous charging positions. Internal LED light to save energy and for best internal visibility. Supplied with 20 pairs of runners to host up to 20 trays 600x800mm or 40 trays 600x400mm.

Main Features

- Right hinged two 1/2 doors.
- Adjustable temperature range from -2°C to +7°C.
- CFC and HCFC free (refrigerant type: R404a)
- Air conveyors and ducts ensure an even airflow and consistent results.
- Completely automatic defrosting.
- Interior LED light to save energy and for best internal visibility.
- Internal structure with numerous charging positions available to host grids, ensuring higher net capacity and a greater storage space.
- Automatic evaporation of the defrosting water by heating element.
- Insulation thickness: 70 mm wall insulation.
- Removable gasket for easy cleaning operations.
- Mechanical door microswitch to stop the fan once the door is opened to minimize energy waste.
- Large digital display with humidity selection button (low and high), cabinet temperature display and setting.
- Suitable for use in ambient temperature of up to 40°C (climatic class 5).

Construction

- Lockable door.
- Easy access to the main components for maintenance.
- Pressed stainless steel door handle without joints gathering dust and dirt.
- 20 pairs of runners included to host up to 20 trays 600x800mm or 40 trays 600x400mm.
- Water drain available on demand.
- Stainless steel AISI 304 inside and outside (except background).
- Stainless steel AISI 304 runners and supports are easily disassembled.
- Reversible left/right doors on demand.

Included Accessories

- 20 of Pair of runner for cabinet - 600X800mm PNC 728873

Optional Accessories

- Shelf grid for cabinets - 600X800mm PNC 728875

APPROVAL: _____

Front

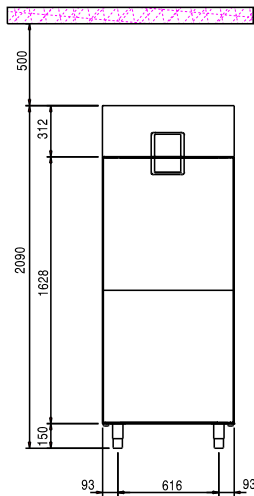

Side

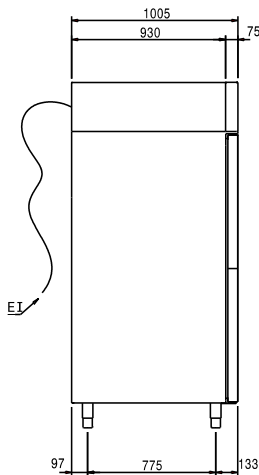

- EI** = Electrical inlet (power)
- RI** = Refrigerant Inlet
- RO** = Refrigerant Outlet

Electric

Supply voltage:

728853 (AFX682HFR) 230 V/1N ph/50 Hz

Electrical power max.:

0.275 kW

Key Information:

Gross capacity: 770 lt

External dimensions, Width: 803 mm

External dimensions, Height: 2090 mm

External dimensions, Depth: 1005 mm

External dimensions, Depth with Doors Open: 1830 mm

Number and type of doors: 2x1/2 ;Full

Type of external material: Stainless Steel AISI 304 Scotch Brite

Type of internal material: 304 AISI

Internal panels material: 304 AISI

Refrigeration Data

Control type: Digital

Refrigerant type: R404a

Refrigeration power at evaporation temperature: -10 °C

Operating temperature min.: -2 °C

Operating temperature max.: 7 °C

Operating mode: Ventilated

Product Information (EU Regulation 2015/1094)

Type of model: