

400 Line 1 Door Freezer (-15/-24) - White

ITEM # _____

MODEL # _____

NAME # _____

SIS # _____

AIA # _____

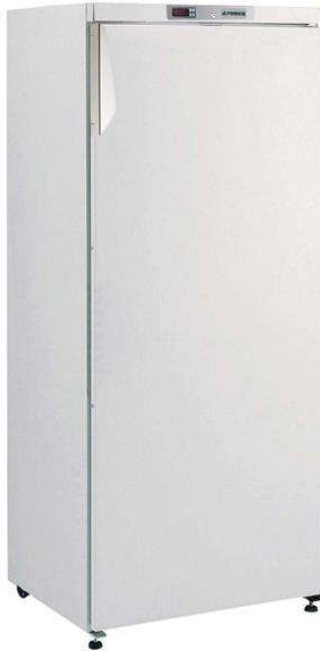

729037 (A4FSFW)

1-door freezer 400lt, -15-24°C,
prepainted white

Short Form Specification

Item No. _____

Exterior in white painted steel. Interior in white High Impact Polystyrene with rounded corners and 45mm thick insulation. Right hinged full door with lock and heated frame, reversible on-site. Built-in refrigeration unit; manual defrost; digital control and temperature display; multiple evaporating grids. For ambient temperatures up to 38°C. HCFC, CFC and HFC free insulation and R404a refrigerant gas. With 2 front feet and 2 back wheels. Supplied with n. 4 evaporating grids.

Main Features

- Digital control panel allowing the easy and precise setting and control of the internal temperature.
- Shelf runners are thermoformed and are incorporated in the internal structure to be easily cleanable.
- CFC and HCFC free (ecological refrigerant type: R404a, gas in foam: cyclopentane).
- Whole interior cell with rounded corners is white thermoformed polystyrene, which is impact resistant.
- Model requires only 1 phase 230V supply and can be plugged straight into an existing power socket.
- Very quiet operation.
- No joints whatsoever to eliminate dirt traps.
- Simple refrigeration system easily accessible from the rear of the units.
- Suitable for use in ambient temperatures of up to 38 ° C.

Construction

- Developed and produced in ISO 9001 and ISO 14001 certified factory.
- All models in range are finished in top quality materials to aid durability.

Optional Accessories

- Pvc container with false bottom for 400lt PNC 881072

APPROVAL: _____

Front

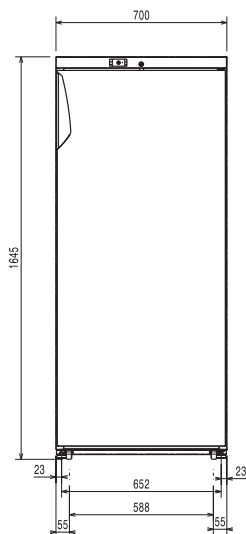

Side

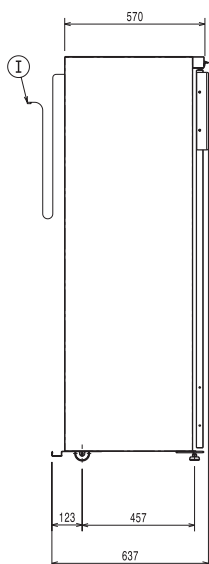

EI = Electrical inlet (power)
RI = Refrigerant Inlet
RO = Refrigerant Outlet

Top

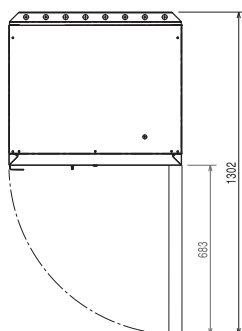

Electric

| | | |
|--|-----------------|------------------|
| Supply voltage: | 729037 (A4FSFW) | 230 V/1 ph/50 Hz |
| Electrical power max.: | | 0.51 kW |
| Defrost Power: | | |
| Current consumption: | | 4.74 Amps |
| Plug type: | | CE-SCHUKO |
| Energy consumption (min,default): | | 0 - 7.81 kW/h |

Key Information:

| | |
|---|---------------------|
| Gross capacity: | 400 lt |
| Net Volume: | |
| Door hinges: | |
| External dimensions, Width: | 700 mm |
| External dimensions, Height: | 1645 mm |
| External dimensions, Depth: | 620 mm |
| Number and type of doors: | 1 Full |
| Internal Dimensions (depth): | 435 mm |
| Internal Dimensions (height): | 1450 mm |
| Internal Dimensions (width): | 610 mm |
| Net weight: | 75 kg |
| Shipping volume: | 0.96 m ³ |
| Height adjustment: | 0/0 mm |
| Number and type of grids (included): | - ;600x400 |

Refrigeration Data

| | |
|--|---------|
| Control type: | Digital |
| Compressor power: | 1/2 hp |
| Refrigerant type: | R404A |
| GWP Index: | 3922 |
| Refrigeration power: | 780 W |
| Refrigeration power at evaporation temperature: | -29 °C |
| Refrigerant weight: | 240 g |
| Min/Max internal humidity: | |
| Operating temperature min.: | -24 °C |
| Operating temperature max.: | -15 °C |
| Operating mode: | Static |

Product Information (EU Regulation 2015/1094)

Type of model: