

400 Line 400lt Line Freezer, 1 Door (White) 60Hz

ITEM # _____

MODEL # _____

NAME # _____

SIS # _____

AIA # _____

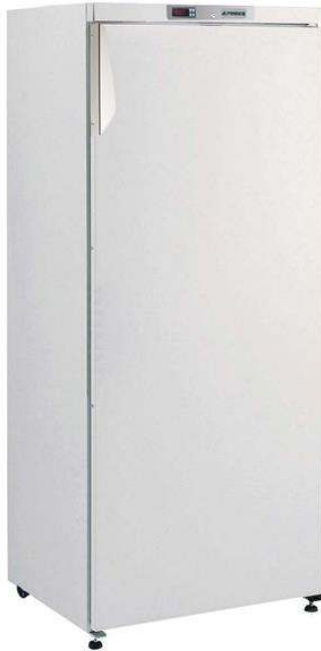

730105 (R04FSFW6)

1-door freezer 400lt, -15-24°C,
prepainted white - 60Hz

Short Form Specification

Item No. _____

Exterior in white painted steel. Interior in white High Impact Polystyrene with rounded corners and 45mm thick insulation. Right hinged full door with lock and heated frame, reversible on-site. Built-in refrigeration unit; manual defrost; digital control and temperature display; multiple evaporating grids. For ambient temperatures up to 38 °C. HCFC, CFC and HFC free insulation and R404a refrigerant gas. With 2 front feet and 2 back wheels. Supplied with n. 4 evaporating grids.

APPROVAL: _____

Main Features

- CFC and HCFC free (ecological refrigerant type: R404a, gas in foam: cyclopentane).
- Digital control panel allowing the easy and precise setting and control of the internal temperature.
- Shelf runners are thermoformed and are incorporated in the internal structure to be easily cleanable.
- Very quiet operation.
- Whole interior cell with rounded corners is white thermoformed polystyrene, which is impact resistant.
- No joints whatsoever to eliminate dirt traps.
- Simple refrigeration system easily accessible from the rear of the units.
- Suitable for use in ambient temperatures of up to 38 ° C.
- Model requires only 1 phase 220V-60Hz supply and can be plugged straight into an existing power socket.

Construction

- Developed and produced in ISO 9001 and ISO 14001 certified factory.
- All models in range are finished in top quality materials to aid durability.

Optional Accessories

- Pvc container with false bottom for 400lt PNC 881072

Front

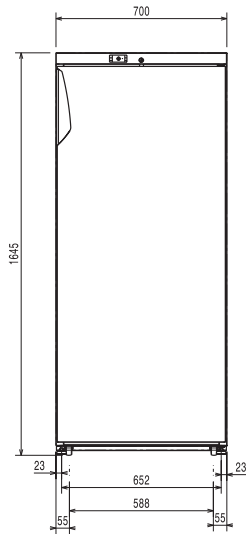

Side

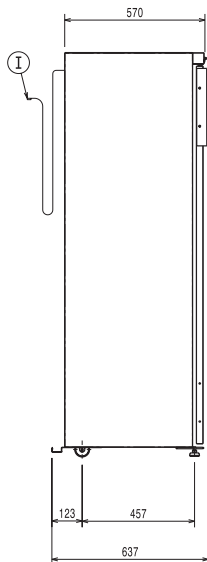

- El = Electrical inlet (power)
- RI = Refrigerant Inlet
- RO = Refrigerant Outlet

Top

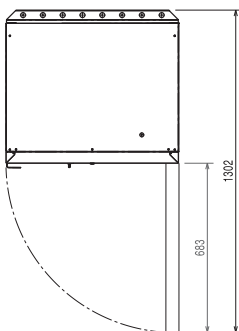

Electric

Supply voltage:	
730105 (R04FSFW6)	220-230 V/1 ph/60 Hz
Electrical power max.:	0.8 kW

Key Information:

Gross capacity:	400 lt
Door hinges:	
External dimensions, Width:	700 mm
External dimensions, Height:	1645 mm
External dimensions, Depth with Doors Open:	1310 mm
Noise level:	56 dBA
Number and type of grids (included):	- ;600x400
Type of external material:	Prepainted Steel
External door material:	Prepainted Steel

Refrigeration Data

Control type:	Digital
Compressor power:	1/2 hp
Refrigerant type:	R404A
Refrigeration power:	780 W
Refrigeration power at evaporation temperature:	-29 °C
Refrigerant weight:	240 g
Operating temperature min.:	-24 °C
Operating temperature max.:	-15 °C
Operating mode:	Static
Cooling unit:	Built-In
Defrost type:	Manual