

## 400 Line 1 Glass Door Freezer (-15/-22) - White

ITEM # \_\_\_\_\_

MODEL # \_\_\_\_\_

NAME # \_\_\_\_\_

SIS # \_\_\_\_\_

AIA # \_\_\_\_\_



729027 (A4FSGGW)

1-glass door freezer,  
400lt, -15-22°C, white

### Short Form Specification

**Item No.** \_\_\_\_\_

External in white prepainted steel. Internal in white thermoformed polystyrene which is impact resistant with rounded corners. Insulation thickness 45mm. Grid runners are thermoformed and incorporated in the inner structure. Right hinged glass door with lock and heated frame. Static operating mode; mechanical control; evaporating grids; manual defrost with waste water device; internal lighting. For ambient temperatures up to 32°C. CFC and HCFC free. R404a gas in refrigeration circuit. Gas in foam: Cyclopentane. Supplied with evaporating grids.

### Main Features

- Digital control panel allowing the easy and precise setting and control of the internal temperature.
- Shelf runners are thermoformed and are incorporated in the internal structure to be easily cleanable.
- CFC and HCFC free (ecological refrigerant type: R404a, gas in foam: cyclopentane).
- Whole interior cell with rounded corners is white thermoformed polystyrene, which is impact resistant.
- Model requires only 1 phase 230V supply and can be plugged straight into an existing power socket.
- Very quiet operation.
- No joints whatsoever to eliminate dirt traps.
- Simple refrigeration system easily accessible from the rear of the units.
- Suitable for use in ambient temperatures of up to 32 ° C.

### Construction

- Developed and produced in ISO 9001 and ISO 14001 certified factory.
- All models in range are finished in top quality materials to aid durability.

APPROVAL: \_\_\_\_\_

**Front**

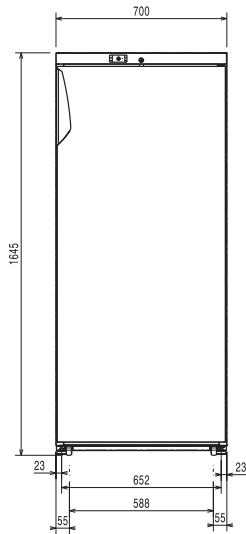

**Side**

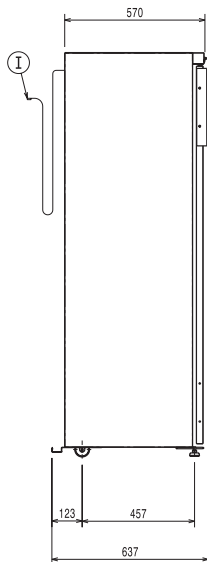

**EI** = Electrical inlet (power)  
**RI** = Refrigerant Inlet  
**RO** = Refrigerant Outlet

**Top**

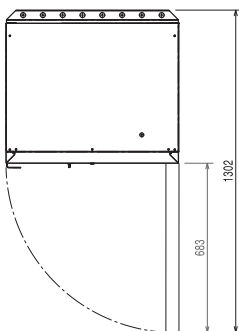

### Electric

Supply voltage:	729027 (A4FSGGW)	230 V/1 ph/50 Hz
Electrical power max.:		0.8 kW
Defrost Power:		
Current consumption:		5 Amps
Plug type:		CE-SCHUKO
Energy consumption (min,default):		0 - 15.56 kW/h

### Key Information:

Gross capacity:	400 lt
Net Volume:	
Door hinges:	
External dimensions, Width:	700 mm
External dimensions, Height:	1645 mm
External dimensions, Depth:	620 mm
Number and type of doors:	1 Glass
Internal Dimensions (depth):	435 mm
Internal Dimensions (height):	1450 mm
Internal Dimensions (width):	610 mm
Net weight:	89 kg
Shipping volume:	0.93 m <sup>3</sup>
Height adjustment:	0/0 mm
Number and type of grids (included):	- 600x400

### Refrigeration Data

Control type:	Digital
Compressor power:	3/4 hp
Refrigerant type:	R404A
GWP Index:	3922
Refrigeration power:	372 W
Refrigeration power at evaporation temperature:	-30 °C
Refrigerant weight:	240 g
Min/Max internal humidity:	
Operating temperature min.:	-22 °C
Operating temperature max.:	-15 °C
Operating mode:	Static

### Product Information (EU Regulation 2015/1094)

Type of model: