

400 Line 400lt Line Refrigerator 1 Door (White) 60Hz

ITEM # _____

MODEL # _____

NAME # _____

SIS # _____

AIA # _____



730104 (R04PVFW6)

1-door refrigerator 400lt,
0+10°C, prepainted white,
60Hz

Short Form Specification

Item No. _____

Exterior in white painted steel. Interior in white High Impact Polystyrene with rounded corners and 45mm thick insulation. Right hinged full door with lock, reversible on-site. Built-in refrigeration unit; ventilated operating mode; automatic defrost and evaporation of defrost water; digital control and temperature display. For ambient temperatures up to 43°C. HCFC, CFC and HFC free insulation and R134a refrigerant gas. With 2 front feet and 2 back wheels.

Supplied with n. 4 grids 600x400mm, PE coated.

Main Features

- Digital control panel allowing the easy and precise setting and control of the internal temperature.
- Shelf runners are thermoformed and are incorporated in the internal structure to be easily cleanable.
- Very quiet operation.
- Whole interior cell with rounded corners is white thermoformed polystyrene, which is impact resistant.
- No joints whatsoever to eliminate dirt traps.
- Simple refrigeration system easily accessible from the rear of the units.
- Fan assisted cooling for even temperature distribution.
- Model equipped with roll-bond plate that has a plate installed in the internal backside of the unit equipped with a special thermostat to avoid ice formation.
- Model requires only 1 phase 220V-60Hz supply and can be plugged straight into an existing power socket.

Construction

- CFC and HCFC free (ecological refrigerant type: R134a, - gas in foam: cyclopentane).
- Developed and produced in ISO 9001 and ISO 14001 certified factory.
- All models in range are finished in top quality materials to aid durability.

Included Accessories

- 2 of Pair of white grids for 400lt refrigerators PNC 880292

Optional Accessories

- Pair of white grids for 400lt refrigerators PNC 880292
- Pvc container with false bottom for 400lt PNC 881072

APPROVAL: _____

Front

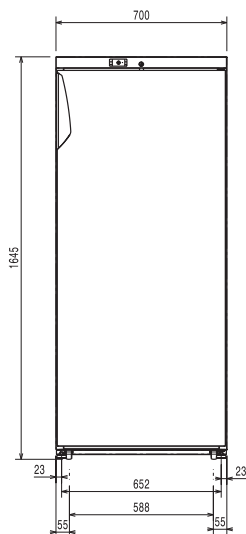

Side

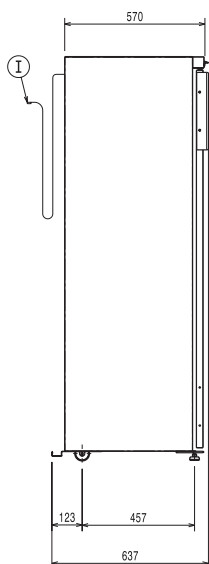

- EI** = Electrical inlet (power)
- RI** = Refrigerant Inlet
- RO** = Refrigerant Outlet

Top

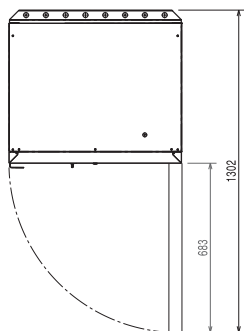

Electric

Supply voltage:	
730104 (R04PVFW6)	220-230 V/1 ph/60 Hz
Electrical power max.:	0.22 kW

Key Information:

Gross capacity:	400 lt
Door hinges:	
External dimensions, Width:	700 mm
External dimensions, Height:	1645 mm
External dimensions, Depth with Doors Open:	1310 mm
Noise level:	53,5 dBA
Number and type of grids (included):	4 - 600x400
Type of external material:	Prepainted Steel
External door material:	Prepainted Steel

Refrigeration Data

Control type:	Digital
Compressor power:	1/5 hp
Refrigerant type:	R134a
Refrigeration power:	306 W
Refrigeration power at evaporation temperature:	-12 °C
Refrigerant weight:	240 g
Min/Max internal humidity:	70%/84%
Operating temperature min.:	0 °C
Operating temperature max.:	10 °C
Operating mode:	Ventilated
Cooling unit:	Built-In
Defrost type:	Automatic (air)