

## 400 Line 1 Glass Door Wine Refrigerator (+4/+19) - Black with wooden shelves

ITEM # \_\_\_\_\_

MODEL # \_\_\_\_\_

NAME # \_\_\_\_\_

SIS # \_\_\_\_\_

AIA # \_\_\_\_\_



729039 (A4P6SWB)

1-glass door wine refrigerator  
400lt, +4/+19°C, black finishing  
and smoked grey glass,  
wooden shelves

### Short Form Specification

Item No. \_\_\_\_\_

Exterior in black painted steel. Interior in grey High Impact Polystyrene with rounded corners and 45mm thick insulation. Right hinged "smoked grey" glass door with lock, reversible on-site. Built-in refrigeration unit; black control panel; electro-mechanical control; internal light. Cell temperatures: upper part +16/+19°C; +13/+15°C; middle part +10/+12°C; +7/+9°C; lower part +4/+7°C. For ambient temperatures up to 32°C. HCFC, CFC and HFC free insulation and R134a refrigerant gas.

Supplied with n. 3 wooden shelves 600x400mm and n. 1 grid 600x285mm PE coated.

APPROVAL: \_\_\_\_\_

### Main Features

- Attractive presentation through glass door and lighting.
- Different temperatures for different zones in the cavity to store different types of wines.
- Shelf runners are thermoformed and are incorporated in the internal structure to be easily cleanable.
- Whole interior cell with rounded corners is white thermoformed polystyrene, which is impact resistant.
- Model requires only 1 phase 230V supply and can be plugged straight into an existing power socket.
- Very quiet operation: noise level less than 55 dB (A).
- No joints whatsoever to eliminate dirt traps.
- Simple refrigeration system easily accessible from the rear of the units.
- Suitable for use in ambient temperatures of up to 32 °C.
- Model equipped with roll-bond plate that has a plate installed in the internal backside of the unit equipped with a special thermostat to avoid ice formation.

### Construction

- Developed and produced in ISO 9001 and ISO 14001 certified factory.
- All models in range are finished in top quality materials to aid durability.
- CFC and HCFC free (ecological refrigerant type: R134a, - gas in foam: cyclopentane).

### Included Accessories

- 1 of kit for 3 wooden shelves for 400lt wine refrigerator PNC 880187

### Optional Accessories

- 3 rilsan grids for 400lt wine refrigerator PNC 880131
- Inclined rilsan shelf for 400lt wine refrigerator PNC 880138

**Front**

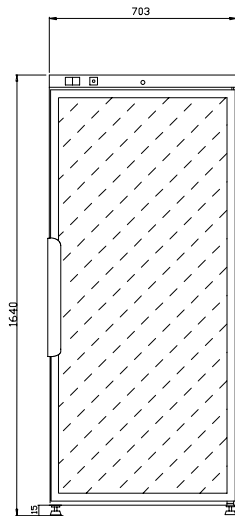

**Side**

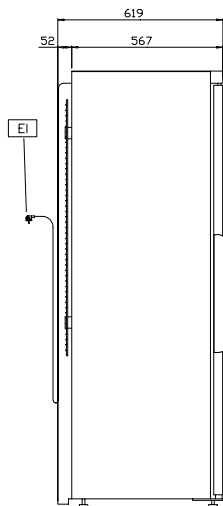

**EI** = Electrical inlet (power)  
**RI** = Refrigerant Inlet  
**RO** = Refrigerant Outlet

**Top**

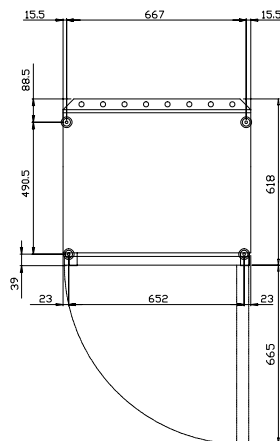

### Electric

Supply voltage:	729039 (A4P6SWB)	230 V/1 ph/50 Hz
Electrical power max.:		0.21 kW
Defrost Power:		
Current consumption:		1.7 Amps
Plug type:		CE-SCHUKO
Energy consumption (min,default):		0 - 0 kW/h

### Key Information:

Gross capacity:	400 lt
Net Volume:	
Door hinges:	
External dimensions, Width:	700 mm
External dimensions, Height:	1640 mm
External dimensions, Depth:	620 mm
Number and type of doors:	1 Glass
Internal Dimensions (depth):	435 mm
Internal Dimensions (height):	1450 mm
Internal Dimensions (width):	610 mm
Net weight:	89 kg
Shipping volume:	0.9 m <sup>3</sup>
Height adjustment:	0/0 mm
Number and type of grids (included):	3 - 600x400

### Refrigeration Data

Control type:	Mechanical
Compressor power:	1/5 hp
Refrigerant type:	R134a
GWP Index:	1430
Refrigeration power:	156 W
Refrigeration power at evaporation temperature:	0 °C
Refrigerant weight:	240 g
Min/Max internal humidity:	70/70
Operating temperature min.:	4 °C
Operating temperature max.:	19 °C
Operating mode:	Static

### Product Information (EU Regulation 2015/1094)

**Energy Class:**  
**Yearly and daily energy consumption:**  
**Climate class:**  
**Energy Efficiency Index (EEI):**  
**Type of model:**

400 Line  
1 Glass Door Wine Refrigerator (+4/+19) - Black with wooden shelves

The company reserves the right to make modifications to the products without prior notice. All information correct at time of printing.