

## 400 Line 1 Door Freezer (-15/-24) - White (R290)

ITEM # \_\_\_\_\_

MODEL # \_\_\_\_\_

NAME # \_\_\_\_\_

SIS # \_\_\_\_\_

AIA # \_\_\_\_\_

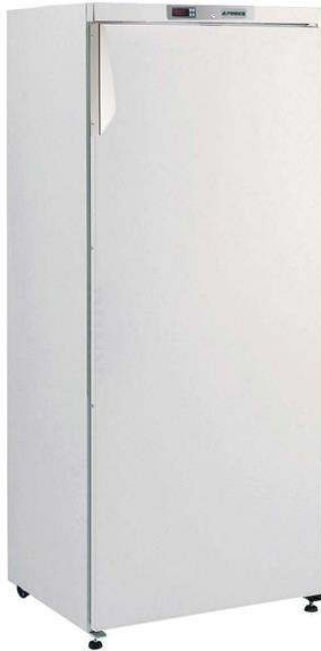

729578 (A4FSFW)

1-door freezer 400lt, -15-24°C,  
prepainted white

### Short Form Specification

Item No. \_\_\_\_\_

Exterior in white painted steel. Interior in white High Impact Polystyrene with rounded corners and 45mm thick insulation. Right hinged full door with lock and heated frame, reversible on-site. Built-in refrigeration unit; manual defrost; digital control and temperature display; multiple evaporating grids. For ambient temperatures up to 38°C. HCFC, CFC and HFC free insulation and R290 refrigerant gas. With 2 front feet and 2 back wheels. Supplied with n. 4 evaporating grids.

APPROVAL: \_\_\_\_\_

### Main Features

- CFC and HCFC free (highly ecological refrigerant type: R290).
- Digital control panel allowing the easy and precise setting and control of the internal temperature.
- Shelf runners are thermoformed and are incorporated in the internal structure to be easily cleanable.
- Whole interior cell with rounded corners is white thermoformed polystyrene, which is impact resistant.
- Model requires only 1 phase 230V supply and can be plugged straight into an existing power socket.
- Very quiet operation.
- No joints whatsoever to eliminate dirt traps.
- Simple refrigeration system easily accessible from the rear of the units.
- Suitable for use in ambient temperatures of up to 38 ° C.

### Construction

- Developed and produced in ISO 9001 and ISO 14001 certified factory.
- All models in range are finished in top quality materials to aid durability.

### Optional Accessories

- PVC container with false bottom for 400L  PNC 881072

### Front

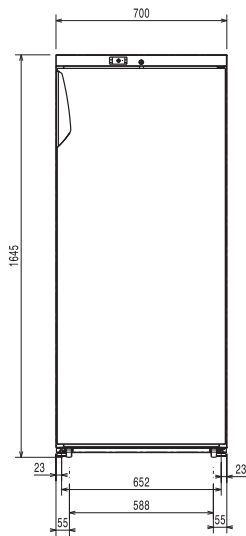

### Side

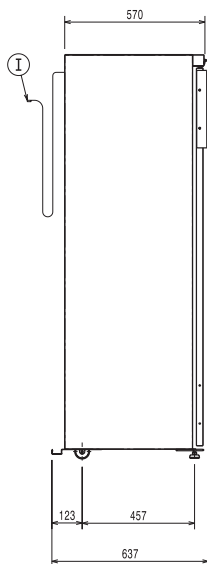

- EI = Electrical inlet (power)
- RI = Refrigerant Inlet
- RO = Refrigerant Outlet

### Top

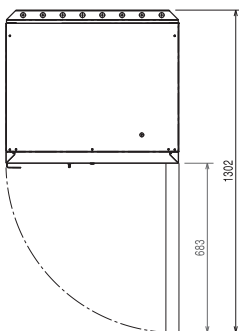

### Electric

Supply voltage:	729578 (A4FSFW)	/1 ph/50 Hz
Electrical power max.:		0.51 kW
Current consumption:		4.74 Amps
Plug type:		CE-SCHUKO

### Key Information:

External dimensions, Width:	700 mm
External dimensions, Height:	1645 mm
External dimensions, Depth:	620 mm
Number and type of doors:	1 Full
Internal Dimensions (depth):	435 mm
Internal Dimensions (height):	1450 mm
Internal Dimensions (width):	610 mm
Net weight:	75 kg
Shipping volume:	0.96 m <sup>3</sup>
Number and type of grids (included):	- ;600x400

### Refrigeration Data

Control type:	Digital
Compressor power:	1/2 hp
Refrigerant type:	R290
GWP Index:	3
Refrigeration power:	780 W
Refrigeration power at evaporation temperature:	-29 °C
Operating temperature min.:	-24 °C
Operating temperature max.:	-15 °C
Operating mode:	Static