

ALPENINOX

CRIO Chill Power Blast Chiller-Freezer 6 1/1 - 30kg - Tower installation with USB-R452a

ITEM # _____

MODEL # _____

NAME # _____

SIS # _____

AIA # _____



728949 (EABCS31CT)

Blast chiller/freezer, for tower execution with 6xGN 1/1 or 600x400 mm (18 levels pitch 20mm), 30/25 kg, lengthwise with USB (R452a)

Short Form Specification

Item No.

For 6 GN1/1 or 600x400 mm trays. Up to 9 ice cream basins 5kg (mm 165x360x125h). 18 levels, pitch 20mm. Load capacity: chilling 30 kg; freezing 25 kg (UK guidelines). Compatible with Electrolux, Alpeninox and Rational SCC Lengthwise ovens. Main components in 304 AISI stainless steel. Internal rounded corners and drain. Built-in refrigeration unit. Cruise cycle for fully automatic blast chilling with food probe. Automatic detection of food probe insertion. Automatic and Manual defrost. Blast chilling real residual time estimation (A.R.T.E.). Turbo cooling function. Specific cycles for ice cream. Evaporator with antirust protection. Digital temperature and time display. HACCP and Service alarms with data logging. Operating air temperature: +90 -41°C. Cyclopentane insulation (HCFC, CFC and HFC free). R452a refrigerant gas (HCFC and CFC free). Suitable for tower configuration.

Main Features

- Blast Freezing cycle: 25 kg from 90°C up to -18°C in less than four hours.
- Blast Chilling cycle: 30 kg from +90°C up to +3°C in less than 90 minutes.
- Soft Chilling (air temperature -2°C).
- Hard Chilling (air temperature -20°C).
- Shock freezing (low air temperature adjustable up to -41°C).
- Holding at +3 °C for chilling or -22 °C for freezing, automatically activated at the end of each cycle, to save energy and maintain the target temperature (manual activation is also possible).
- Turbo cooling: chiller works continuously at the desired temperature; ideal for continuous production.
- Cruise cycle: the chiller automatically sets the parameters for the quickest and best chilling (it works by probe).
- Two specialized cycles:
P1 brings down ice-cream temperature to -14°C (measured at the core when probe is inserted). Once set temperature is reached, the temporary maintenance phase automatically begins, holding the -14°C temperature.
P2 sets temperature to -36°C/-40°C for an indefinite amount of time, maintaining the ventilation active. Temperature is adjustable up to -40°C without interrupting the cycle, allowing ice-cream to be kept longer in the freezer.
- Control unit provides several operating settings (programmable parameters): time/core temperature according to NF and UK regulations, time/air temperature/probe personalized according to national regulations, sterilizing cycle: UV lamps built-in (on request), 3 single sensor or 3-sensor temperature probes (as accessory), ideal for meats, automatic defrosting and manual defrosting.
- 3-sensor core probe as standard and automatic detection of the core probe insertion.
- Probe-driven cycles feature ARTE (Algorithm for Remaining Time Estimation) to make planning the activities easier.
- Control unit provides two large displays to read out: time, core temperature, cycle countdown, alarms, service information.
- Audible alarm starts when the cycle ends or terminates abnormally.
- All information related to the different operating models are recorded: date, time, cycle, core temperature, holding temperature, HACCP accordance.
- Suitable for tower installation.
- Multi-purpose internal structure is suitable for 6 grids GN 1/1 (18 positions available with 20 mm pitch) 6 grids or trays 600 x 400 mm (18 positions available with 20 mm pitch) or 9 ice-cream basins of 5 kg each (h 125 x 165 x 360).
- Performance guaranteed at ambient temperatures of +43°C.
- USB connection: to download HACCP data from the blast chiller (time, cavity temperature, alarms, and probe temperature).

APPROVAL: _____

Construction

- Main components in 304 AISI stainless steel.
- Developed and produced in ISO 9001 and ISO 14001 certified factory.
- Evaporator with antirust protection.
- Motors and fan waterproof protected IP23.
- PC connection on request, gate RS 485.
- Stand alone printer as accessory.
- Inner cell with fully rounded corners.
- High density polyurethane insulation, 60 mm thickness, HCFC free.
- Removable magnetic gasket door with hygienic design.
- Ventilator swinging hinged panel for access to the evaporator for cleaning.
- Automatic heated door frame.
- Thermostatic expansion valve to optimize the cooling unit efficiency.
- Solenoid valve included.
- No water connections required.
- Waste water can be plumbed into drain, but can also be collected in an optional waste container.
- Internal and external finishing in 304 AISI stainless steel and backpanel in galvanized steel.
- Environmentally friendly: R452a as refrigerant fluid.

Included Accessories

- 1 of 3 sensor probe for blast chiller and blast chiller/freezers PNC 880212
- 1 of Set of 5 stainless steel runners for blast chiller LW 30 and 50kg PNC 880312

Optional Accessories

- Kit of HACCP advanced connection for blast chiller and blast chiller/freezers PNC 880183
- 3 sensor probe for blast chiller and blast chiller/freezers PNC 880212
- 1 single-sensor probe for blast chiller and blast chiller&freezer PNC 880213
- 2 single sensor probes for blast chiller-freezer PNC 880214
- 3 single sensor probes for blast chiller-freezer PNC 880215
- Pastry grid in rilsan (400x600 mm) for 70 kg blast chillers/blast chiller freezers PNC 880294
- Set of 5 stainless steel runners for blast chiller LW 30 and 50kg PNC 880312
- Plastic coated grid for refrigerated counters PNC 881061
- Kit buzzer for Blast chiller/Freezer Lengthwise with USB PNC 881143
- Pair of 1/1 GN grids in 304 AISI PNC 921101
- Kit HACCP EKIS PNC 922166

Front

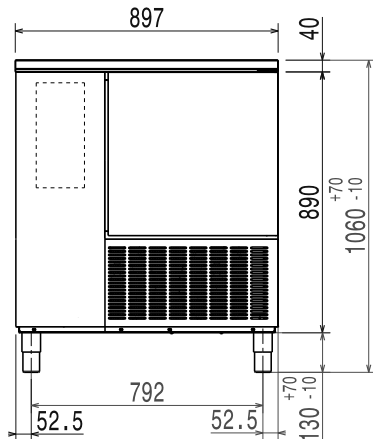

Side

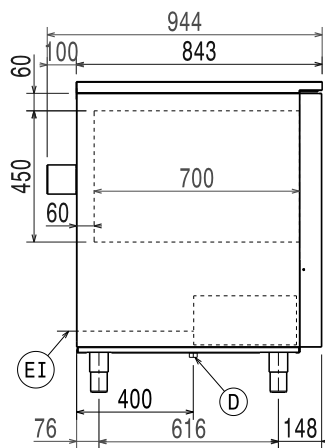

- D** = Drain
- EI** = Electrical inlet (power)
- RO** = Refrigerant Outlet

Top

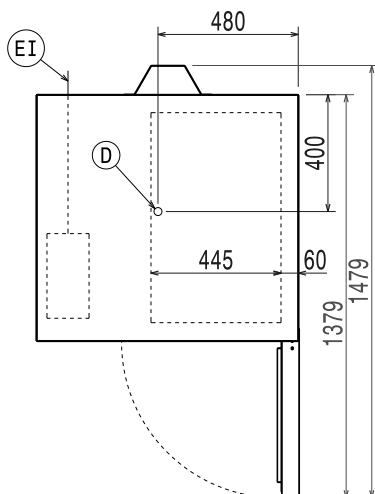

Electric

Supply voltage:	728949 (EABCS31CT)	380-415 V/3N ph/50 Hz
Electrical power max.:		2.39 kW
Circuit breaker required		

Installation:

Clearance: 5 cm on sides and back.
Please see and follow detailed installation instructions provided with the unit

Capacity:

GN:	6 - 1/1 containers
Max load capacity:	30 kg

Key Information:

External dimensions, Width:	897 mm
External dimensions, Height:	1020 mm
External dimensions, Depth:	944 mm
Shipping weight:	199 kg
Shipping volume:	1.29 m ³

Refrigeration Data

Control type:	Electronic
Compressor power:	1,8 hp
Refrigerant type:	R452A
Refrigeration power:	1600 W
Refrigeration power at evaporation temperature:	-30 °C
Refrigerant weight:	1800 g

Product Information (Commission Regulation EU 2015/1095)

Energy consumption, cycle (chilling):	0.09 kWh/kg
Chilling Cycle Time (+65°C to +10°C):	76 min
Full load capacity (chilling):	30 kg
Energy consumption, cycle (freezing):	0.271 kWh/kg
Freezing Cycle Time (+65°C to -18°C):	242 min
Full load capacity (freezing):	25 kg