

Roll-in 1 Door Refrigerator, 930lt (0/+10) - SMART

ITEM # _____

MODEL # _____

NAME # _____

SIS # _____

AIA # _____



728820 (ARI093RE1F)

1-door roll-in refrigerator 930lt,
0/+10°C, smart electronic, AISI
304

Short Form Specification

Item No. _____

External and internal in AISI 304 stainless steel. Insulation thickness 60mm. Left hinged full door with lock. Bottom door gasket adjustable. Built-in refrigeration unit; ventilated operating mode. Digital control panel; temperature display; humidity control; hidden evaporator; automatic defrost. Electronic Control: HACCP incorporated; defrost cycle is activated when the probe senses ice in the evaporator; should a probe break the system records its performance of the last 24h; 4 probes constantly control working condition of the appliance; temperature and humidity of food stored can be set by pushing a button. Operating temperature 0/+10°C. For ambient temperatures up to 43°C. CFC and HCFC free. R134a gas in refrigeration circuit. Gas in foam: Cyclopentane.

Main Features

- Smart electronic control features:
 - HACCP: when temperature exceeds critical limits, acoustic and visual alarms are activated. All events are recorded, displaying date and time
 - IQ4 Defrost: the defrost cycle is activated only when ice in the evaporator is detected by a dedicated probe
 - Intelligence when failure: when a probe breaks, the performances of the last 24h of operation are recorded and continues to work
 - Diagnostic: four probes constantly monitor the working conditions of the appliance
 - Food categories: depending on the type of food stored, the appropriate temperature and humidity level can be set by just pushing a button
- Ventilated cooling for optimal temperature distribution.
- Digital control panel with temperature display.
- Automatic defrost.
- The operating temperature can be adjusted from 0 to +10 °C to suit both meat and dairy storage requirements.

Construction

- The whole interior cell is constructed of AISI 304 stainless steel with rounded corners for a better cleanability.
- External panels are in AISI 304 stainless steel for higher level of hygiene.
- Evaporator and fan are placed outside the cell to provide the maximum storage capacity.
- Evaporator cover is easily removable for service.
- Cabinet fitted with up to 60 mm thickness of Cyclopentane insulation for best insulating performance (thermal conductivity: 0,020 W/m*K). CFC and HCFC-free insulation.
- Refrigerant type: R134a.
- Lockable door.

Optional Accessories

- Kit for HACCP advanced version (for cabinets and counters with electronic control) PNC 880090
- Trolley with tray rack, 20 GN 1/1, 63mm pitch (included) PNC 922007

APPROVAL: _____

Front

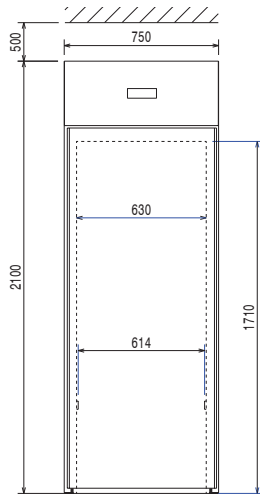

Side

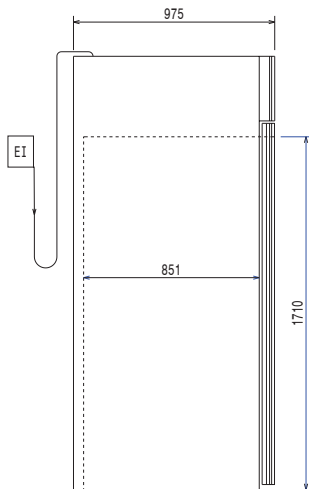

EI = Electrical inlet (power)
RI = Refrigerant Inlet
RO = Refrigerant Outlet

Top

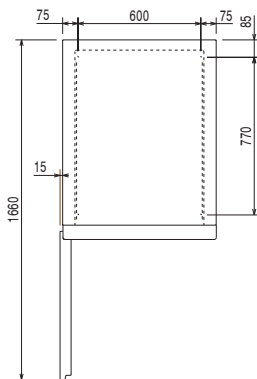

Electric

Supply voltage:

728820 (ARI093RE1F) 230 V/1 ph/50 Hz

Electrical power max.:

0.46 kW

Key Information:

Gross capacity: 930 lt

N° of doors: 1

Door hinges:

External dimensions, Width: 750 mm

External dimensions, Height: 2110 mm

External dimensions, Depth: 980 mm

Built-in Compressor and Refrigeration Unit

Type of external material: 304 AISI

Type of internal material: 304 AISI

External side panels: 304 AISI

External top panels: Galvanized Steel

External door material: 304 AISI

Internal panels material: 304 AISI

Refrigeration Data

Control type: Electronic

Compressor power: 3/8 hp

Refrigerant type: R134a

Refrigeration power: 456 W

Refrigeration power at evaporation temperature: -10 °C

Refrigerant weight: 260 g

Min/Max internal humidity: 66/74

Operating temperature min.: 0 °C

Operating temperature max.: 10 °C

Operating mode: Ventilated

Defrost type: Automatic