

Self Service Front Cooking Unit with Shelf - 852mm

ITEM # _____

MODEL # _____

NAME # _____

SIS # _____

AIA # _____



330273 (SSFC2M)

Front cooking unit with shelf
(width 800 mm)

Short Form Specification

Item No. _____

20/10 top, external panelling, base and feet in 304 AISI stainless steel. 2" round feet, adjustable, 200mm in height.

TOP: Recessed Top - mm50 in thickness - suitable to hold electric top appliances.

LOWER COMPARTMENT: Bridge-Type Section open on operator's side.

Equipped with additional shelf, n. 2 electric plugs and sneeze guard.

Main Features

- Flexible and suitable to all server requirements thanks to the wide range of accessories available.
- Complies with main international certification bodies and is CE marked.

Construction

- Stainless steel External panelling and base.
- Adjustable stainless steel feet (up to 200 mm).
- Equipped with plugs for electric connection and sneeze guard.

Optional Accessories

- Right-hand stainless steel end panel, PNC 850074 including kicking strip - uprights for gantry ☐ (operator side)
- Left-hand stainless steel end panel, PNC 850075 including kicking strip - uprights for gantry ☐ (operator side)
- Right-hand stainless steel end panel, PNC 850076 including kicking strip - uprights for gantry ☐ (both sides)
- Left-hand stainless steel end panel, PNC 850077 including kicking strip - uprights for gantry ☐ (both sides)
- Right-hand stainless steel end panel, PNC 850078 including kicking strip - without tray ☐
- Left-hand stainless steel end panel, PNC 850079 including kicking strip - without tray ☐
- Right-hand end element consisting of PNC 856295 cherry-wood finish semicircular side panel, stainless steel top, kicking strip and external covering shells for gantry top and upright ☐
- Left-hand end element consisting of PNC 856296 cherry-wood finish semicircular side panel, stainless steel top, kicking strip and external covering shells for gantry top and upright ☐
- Left-hand end element consisting of PNC 856297 beech-wood finish semicircular side panel, stainless steel top, kicking strip and external covering shells for gantry top and upright ☐
- Right-hand end element consisting of PNC 856298 beech-wood finish semicircular side panel, stainless steel top, kicking strip and external covering shells for gantry top and upright ☐
- Right-hand end element consisting of PNC 856299 cherry-wood finish side panel, stainless steel kicking strip, worktop end panel and external covering shells for gantry top and upright ☐
- Left-hand end element consisting of PNC 856302 cherry-wood finish side panel, stainless steel kicking strip, worktop end panel and external covering shells for gantry top and upright ☐

APPROVAL: _____

- Left-hand end element consisting of beech-wood finish side panel, stainless steel kicking strip, worktop end panel and external covering shells for gantry top and upright PNC 856303 ☐
- Right-hand end element consisting of beech-wood finish side panel, stainless steel kicking strip, worktop end panel and external covering shells for gantry top and upright PNC 856304 ☐
- 2 curved front panels with beech wood finishing PNC 856305 ☐
- 2 front panels with beech wood finishing PNC 856308 ☐
- 2 front panels with cherry wood finishing PNC 856309 ☐
- 2 curved front panels with cherry wood finishing - 450 mm PNC 856310 ☐
- Tray slider with beech wood finishing PNC 856311 ☐
- Tray slider with cherry wood finishing PNC 856330 ☐
- Gantry for front cooking unit PNC 856339 ☐
- Kicking strip, stainless steel PNC 856342 ☐
- Tubular tray slider, stainless steel PNC 856345 ☐
- Right-hand end element consisting of stainless steel side panel (kicking strip included) worktop end panel external covering shells for gantry top and upright PNC 856421 ☐
- Left-hand end element consisting of stainless steel side panel (kicking strip included) worktop end panel external covering shells for gantry top and upright PNC 856422 ☐
- Right-hand end element consisting of stainless steel side panel (without kicking strip) worktop end panel external covering shells for gantry top and upright PNC 856423 ☐
- Left-hand end element consisting of stainless steel side panel (without kicking strip) worktop end panel external covering shells for gantry top and upright PNC 856424 ☐
- Kit of 2 metal worktop covers for units without gantries PNC 856494 ☐

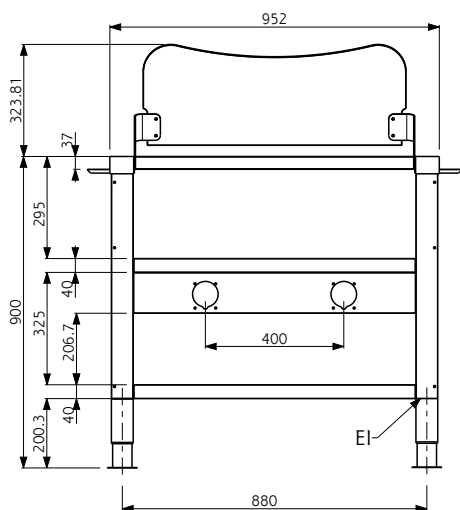
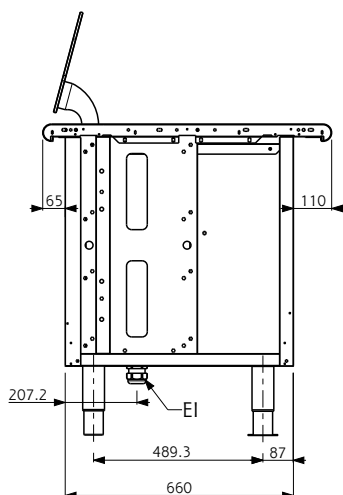
Front

Side

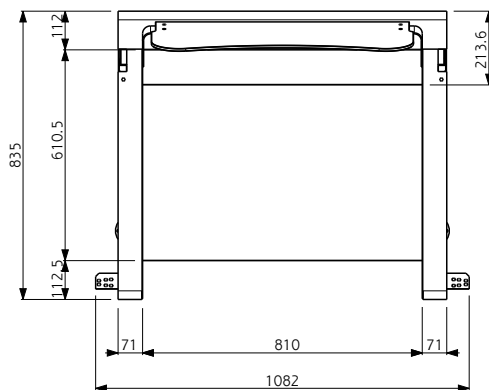
EI = Electrical inlet (power)

Top

Key Information:

| | |
|------------------------------|--------|
| External dimensions, Width: | |
| 330273 (SSFC2M) | 952 mm |
| External dimensions, Height: | 900 mm |
| External dimensions, Depth: | 835 mm |
| Net weight: | 70 kg |
| Foot type: | Round |
| Foot size: | 2" |