

Self Service Bain Marie on Heated Cupboard - 3 GN

ITEM # _____

MODEL # _____

NAME # _____

SIS # _____

AIA # _____

**332000 (ZLB12H)**

Bain-marie, with one well (3 GN container capacity) on heated cupboard with hinged doors

Short Form Specification

Item No. _____

20/10 top, external panelling, base and feet in 304 AISI stainless steel. Insulated construction, CFC and HCFC free. 2" round feet, adjustable, 200mm in height.

BAIN-MARIE WELL, completely welded, in 304 AISI stainless steel with rounded corners on all sides. Well mm955x510x200h (+80+90°C) can accommodate n. 3x1/1GN (not included). Automatic water topping up (when water evaporates).

HOT CUPBOARD mm1160x620x420h (+45+80°C) with n. 3 reinforced and sound-deadened hinged doors. Suitable for storing crockery (dry heat) it can be equipped with frames to hold 1/1GN grids and trays.

One heating system for the well and cupboard allowing a great energy consumption reduction.

Recessed control panel featuring easy-to-read electronic controls: main ON/OFF button, Alarm Service button, HACCP button to monitor and record all the critical events, 2 buttons to increase and decrease temperature, temperature display and thermostat.

Main Features

- Control panel equipped with easy-to-read buttons (ON/OFF, Alarm Service, HACCP, 2 buttons to increase and decrease the temperature and a thermostat) that can not be accidentally knocked.
- Can be equipped with many different kinds of gantries (with stainless steel or tempered glass shelves) with or without heating lights.
- Great reduction of energy consumption thanks to the single heating system for well and cupboard.
- Flexible and suitable to all servery requirements thanks to the wide range of accessories availables.
- Bain Marie well and cupboard separately thermostatically controlled.
- Heated cupboard with reinforced hinged doors that can be equipped with a frame (accessory) to hold grids and trays.
- Well dimensions to accommodate three containers 1/1 GN all with a maximum container height of 200 mm.
- Automatic water charge.
- Bain maries can be supplied both with hot or cold water.
- Complies with main international certification bodies and is CE marked.

Construction

- Completely welded construction.
- Rounded corners well.
- 304 AISI stainless steel 20/10 top, external panelling and base.
- Adjustable stainless steel feet (up to 200 mm).

APPROVAL: _____

Optional Accessories

- Right-hand stainless steel end panel, including kicking strip - uprights for gantry (operator side) PNC 850074 ☐
- Left-hand stainless steel end panel, including kicking strip - uprights for gantry (operator side) PNC 850075 ☐
- Right-hand stainless steel end panel, including kicking strip - uprights for gantry (both sides) PNC 850076 ☐
- Left-hand stainless steel end panel, including kicking strip - uprights for gantry (both sides) PNC 850077 ☐
- Right-hand stainless steel end panel, including kicking strip - without tray PNC 850078 ☐
- Left-hand stainless steel end panel, including kicking strip - without tray PNC 850079 ☐
- Stainless steel tubular tray slider, for 3 GN container capacity units PNC 856039 ☐
- Stainless steel front kicking strip, for 3 GN container capacity units PNC 856073 ☐
- Electrical connection for plate dispensers PNC 856168 ☐
- Couple of beech-wood finish front panels, 400 mm PNC 856187 ☐
- Frame to be placed inside the cupboards as 1/1 GN grids/trays holder (for Hot-not those with humidifying device- & Neutral Units) PNC 856191 ☐
- Cherry-wood finish tray slider, for 3 GN container capacity units PNC 856204 ☐
- Beech-wood finish tray slider, for 3 GN container capacity units PNC 856220 ☐
- Gantry, with one stainless steel shelf, sneeze guard and heating light, for 3 GN container capacity hot units only PNC 856244 ☐
- Gantry, with one glass shelf, sneeze guard and heating lights, for 3 GN container capacity hot units only PNC 856248 ☐
- Gantry, with one stainless steel shelf and sneeze guard, for 3 GN container capacity PNC 856252 ☐
- Gantry, with one glass shelf and sneeze guard, for 3 GN container capacity PNC 856256 ☐
- Gantry, for 3 GN container capacity units PNC 856260 ☐
- Gantry, with one glass shelf for 3 GN container capacity units PNC 856264 ☐
- Gantry, with one glass shelf and cold light, for 3 GN container capacity units PNC 856268 ☐
- Gantry, with two glass shelves and cold light, for 3 GN container capacity units PNC 856272 ☐
- Couple of cherry-wood finish curved front panels, 400 mm PNC 856277 ☐
- Couple of end elements for curved cherry-wood finish front panels PNC 856287 ☐
- Couple of beech-wood finish curved front panels, 400 mm PNC 856288 ☐
- Beech-wood finish curved front panel for 650 mm trolley parking units PNC 856289 ☐
- Couple of end elements for curved beech-wood finish front panels PNC 856294 ☐
- Right-hand end element consisting of cherry-wood finish semicircular side panel, stainless steel top, kicking strip and external covering shells for gantry top and upright PNC 856295 ☐
- Left-hand end element consisting of cherry-wood finish semicircular side panel, stainless steel top, kicking strip and external covering shells for gantry top and upright PNC 856296 ☐
- Left-hand end element consisting of beech-wood finish semicircular side panel, stainless steel top, kicking strip and external covering shells for gantry top and upright PNC 856297 ☐
- Right-hand end element consisting of beech-wood finish semicircular side panel, stainless steel top, kicking strip and external covering shells for gantry top and upright PNC 856298 ☐
- Right-hand end element consisting of cherry-wood finish side panel, stainless steel kicking strip, worktop end panel and external covering shells for gantry top and upright PNC 856299 ☐
- Left-hand end element consisting of cherry-wood finish side panel, stainless steel kicking strip, worktop end panel and external covering shells for gantry top and upright PNC 856302 ☐
- Left-hand end element consisting of beech-wood finish side panel, stainless steel kicking strip, worktop end panel and external covering shells for gantry top and upright PNC 856303 ☐
- Right-hand end element consisting of beech-wood finish side panel, stainless steel kicking strip, worktop end panel and external covering shells for gantry top and upright PNC 856304 ☐
- Couple of cherry-wood finish front panels, 400 mm PNC 856410 ☐
- Right-hand end element consisting of stainless steel side panel (kicking strip included) worktop end panel external covering shells for gantry top and upright PNC 856421 ☐
- Left-hand end element consisting of stainless steel side panel (kicking strip included) worktop end panel external covering shells for gantry top and upright PNC 856422 ☐
- Right-hand end element consisting of stainless steel side panel (without kicking strip) worktop end panel external covering shells for gantry top and upright PNC 856423 ☐
- Left-hand end element consisting of stainless steel side panel (without kicking strip) worktop end panel external covering shells for gantry top and upright PNC 856424 ☐
- 2 side covering shells for gantry top and gantry uprights (external side) to close the gantry when installed near an element without gantry PNC 856425 ☐
- Kit of 3 supports for 1/2 and 1/3 GN container to be used in bain-marie units PNC 856493 ☐
- Kit of 2 metal worktop covers for units without gantries PNC 856494 ☐
- Gantry, with two glass shelves, sneeze guard and heating light, for 3 GN container capacity hot units only PNC 856498 ☐
- Gantry, with one glass shelf, sneeze guard on both sides and cold light, for 3 GN container capacity units PNC 856507 ☐
- Electronic board for HACCP advanced connection for hot units PNC 880093 ☐

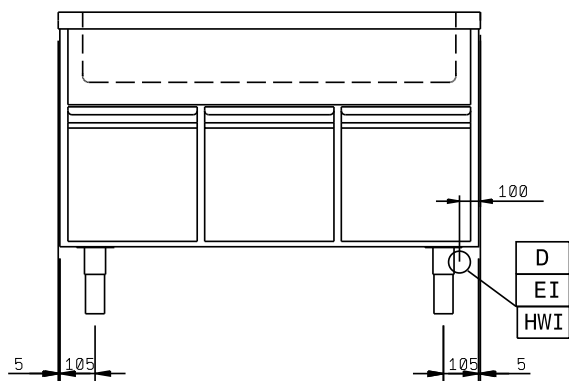
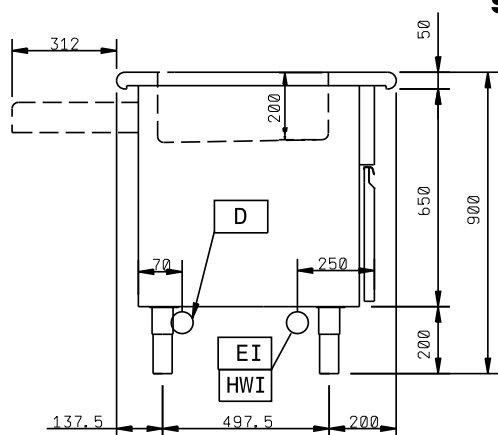
Front

Side

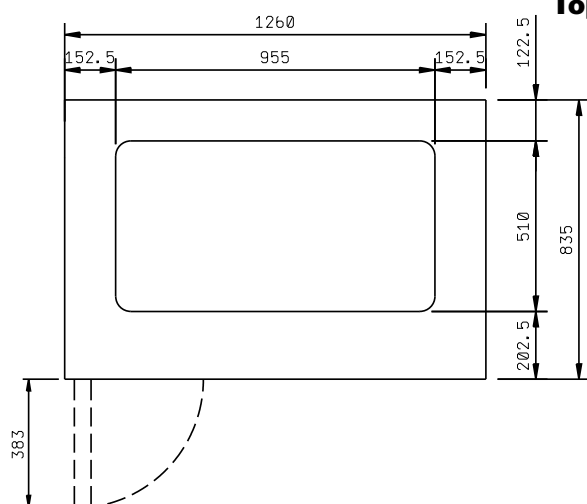
D = Drain
EI = Electrical inlet (power)
HWI = Hot water inlet

Top

Electric

Supply voltage:

332000 (ZLB12H)

400 V/3N ph/50 Hz

Electrical power max.:

3.25 kW

Water:

Water drain outlet size:

3/4"

Water connection - inlet/outlet
pipe size:

3/4"

Key Information:

Cabinet width:	1160 mm
Cabinet depth:	620 mm
Cabinet height:	420 mm
N° of doors:	3
Cabinet temperature:	+45/+80 °C
Door Type:	Hinged
External dimensions, Width:	1260 mm
External dimensions, Height:	900 mm
External dimensions, Depth:	835 mm
Worktop thickness:	50 mm
Net weight:	105 kg
Foot type:	Round
Foot size:	2"