

## Modular Cooking Range Line EVO900 Gas Multifunctional Cooker with compound bottom

ITEM # \_\_\_\_\_

MODEL # \_\_\_\_\_

NAME # \_\_\_\_\_

SIS # \_\_\_\_\_

AIA # \_\_\_\_\_

**392142 (Z9MFGHDIO0)**22-lt gas multifunctional  
cooker with compound  
cooking surface

### Short Form Specification

**Item No.** \_\_\_\_\_

Suitable for natural gas or LPG. Burners to have a double flame line to guarantee heat uniformity. To be installed on 50 mm high feet for cleaning ease. Well to have rounded corners and cooking surface in compound steel (a 3 mm layer of 316 AISI stainless steel on top of a 12 mm layer of mild steel). Exterior panels of unit in stainless steel with Scotch Brite finish.

### Main Features

- Multi purpose cooking appliance that can be used to shallow fry, cook liquids or even as a bain marie. Unit can be used for sautéing, poaching, steaming, simmering, stewing, braising, boiling and preparing white sauces.
- Well cooking surface made in compound steel (a 3mm layer of 316 AISI stainless steel on top of a 12mm layer of mild steel) for optimum grilling results.
- The stainless steel well to have rounded corners to facilitate cleaning.
- Bottom temperature control is precisely set by a thermostat on the control panel.
- Temperature can be set from 100 °C to 250 °C.
- Uniform temperature distribution over the whole base.
- Short heat-up time of the empty pan.
- Burners equipped with double flame line for better heat distribution.
- The special design of the control knob system guarantees against water infiltration.

### Construction

- All exterior panels in Stainless Steel with Scotch Brite finishing.
- Delivered with runners for gastronorm container.

APPROVAL: \_\_\_\_\_

**Included Accessories**

- 1 of Scraper for smooth plate for fry tops PNC 164255

**Optional Accessories**

- Scraper for smooth plate for fry tops PNC 164255 ☐
- Junction sealing kit PNC 206086 ☐
- Draught diverter, 150 mm diameter PNC 206132 ☐
- Matching ring for flue condenser, 150 mm diameter PNC 206133 ☐
- 4 wheels, 2 swivelling with brake (EVO700/900). It is mandatory to install with base supports for feet/wheels. PNC 206135 ☐
- Flanged feet kit PNC 206136 ☐
- Frontal kicking strip for concrete installation, 800 mm PNC 206148 ☐
- Frontal kicking strip for concrete installation, 1000 mm PNC 206150 ☐
- Frontal kicking strip for concrete installation, 1200 mm PNC 206151 ☐
- Frontal kicking strip for concrete installation, 1600 mm PNC 206152 ☐
- Pair of side kicking strips (concrete installation) PNC 206157 ☐
- Side handrail for right/left hand PNC 206165 ☐
- Frontal handrail 800 mm PNC 206167 ☐
- Frontal kicking strip, 800 mm PNC 206176 ☐
- Frontal kicking strip, 1000 mm PNC 206177 ☐
- Frontal kicking strip, 1200 mm PNC 206178 ☐
- Frontal kicking strip, 1600 mm PNC 206179 ☐
- Pair of side kicking strips PNC 206180 ☐
- 2 panels for service duct (single installation) PNC 206181 ☐
- Large handrail (portioning shelf) 800 mm PNC 206186 ☐
- Frontal handrail 1200 mm PNC 206191 ☐
- Frontal handrail 1600 mm PNC 206192 ☐
- 2 panels for service duct (back to back installation) PNC 206202 ☐
- 4 feet for concrete installation (not for 900 line freestanding grill) PNC 206210 ☐
- Central support for installation of drawers and grid supports for open base cupboards PNC 206245 ☐
- Flue condenser for 1 module, 150 mm diameter PNC 206246 ☐

- Electric heating kit for cupboards PNC 206259 ☐
- Chimney upstand, 800 mm PNC 206304 ☐
- 2 side covering panels, height 700 mm, depth 900 mm PNC 206335 ☐
- Door for open base cupboard PNC 206342 ☐
- 2 drawers for open base, height 100 mm PNC 206361 ☐
- Base support for feet or wheels - 800mm (EVO700/900) PNC 206367 ☐
- Base support for feet or wheels - 1200mm (EVO700/EVO900) PNC 206368 ☐
- Base support for feet or wheels - 1600mm (EVO700/900) PNC 206369 ☐
- Base support for feet or wheels - 2000mm (EVO700/900) PNC 206370 ☐
- Rear paneling - 800mm (EVO700/900) PNC 206374 ☐
- Rear paneling - 1000mm (EVO700/900) PNC 206375 ☐
- Rear paneling - 1200mm (EVO700/900) PNC 206376 ☐
- Chimney grid net, 400mm PNC 206400 ☐
- Lid for 22lt multifunctional cooker PNC 921690 ☐
- Blades with rounded sides for scraper for multifunctional cookers PNC 921694 ☐
- Pressure regulator for gas units PNC 927225 ☐

# Modular Cooking Range Line EVO900 Gas Multifunctional Cooker with compound bottom

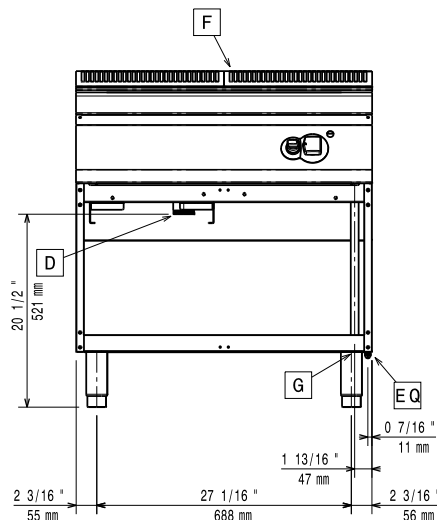
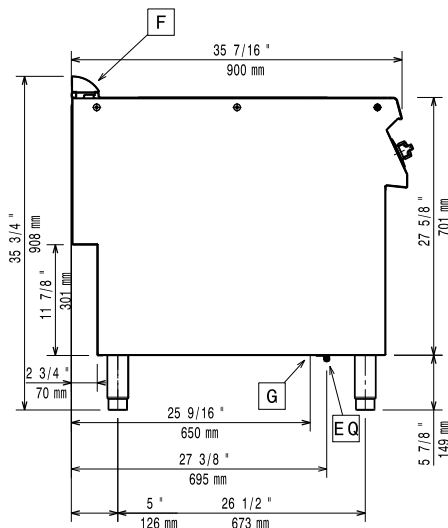
**Front**

**Side**

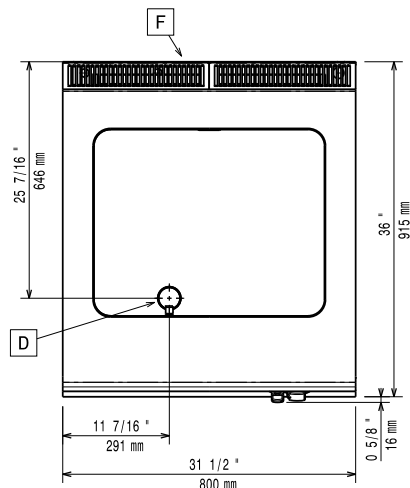
EQ = Equipotential screw  
G = Gas connection

**Top**

## Gas

### Gas Power:

392142 (Z9MFGHD100)

14 kW

### Standard gas delivery:

Natural Gas G20 (20mbar)

### Gas Type Option:

LPG; Natural Gas

### Gas Inlet:

1/2"

## Key Information:

Cooking surface width:

630 mm

Cooking surface depth:

509 mm

Working Temperature MIN:

100 °C

Working Temperature MAX:

250 °C

Net weight:

115 kg

Shipping weight:

99 kg

Shipping height:

1120 mm

Shipping width:

1020 mm

Shipping depth:

860 mm

Shipping volume:

0.98 m³

Certification group:

N9EBRG

If appliance is set up or next to or against temperature sensitive furniture or similar, a safety gap of approximately 150 mm should be maintained or some form of heat insulation fitted.